

SUB PLATE FOR PACKING EB3..3..  
 GRUNDPLATTE FUER VERKETTUNGEN EB3..3..

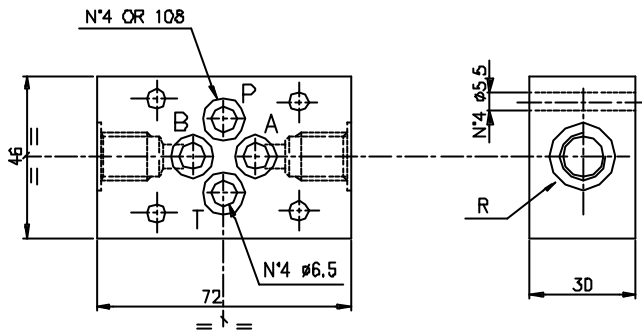

Sub plate for packing type EB3... Weight = 0.6 Kg  
 Grundplatte fuer Verkettungen typ EB3... Gewicht = 0.6 Kg



type/Typ	use/Nutz.
0	A + B
3	P + T
6	P + P
7	T + T

Ordering code  
 Bestell-Code

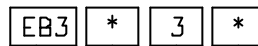

sub plate for packing = B  
 Grundplatte fuer Verkettungen

14 =R 1/4"G  
 38 =R 3/8"G

Type / Typ 0-3-6-7 CETOP 3

See the tablet / Sehen die tabelle

Sub plate for packing with A-B-P-T threaded M8x1. Weight = 0.3 Kg  
 Grundplatte fuer Verkettungen mit A-B-P-T Gewindeanschlussen M8x1.  
 Gewicht = 0.3 Kg

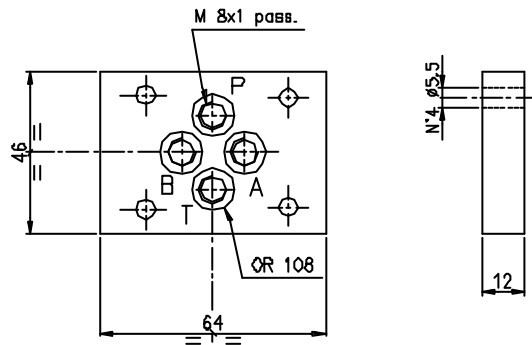

Hydr. symbol  
 Symbol



Ordering code  
 Bestell-Code

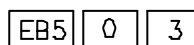

sub plate for packing = B5  
 with threaded M8x1  
 Grundplatte fuer Verkettungen  
 mit Gewindeanschlussen M8x1

CETOP 3  
 0 = version with A-B-P-T threaded  
 A-B-P-T Gewindeanschlussen